

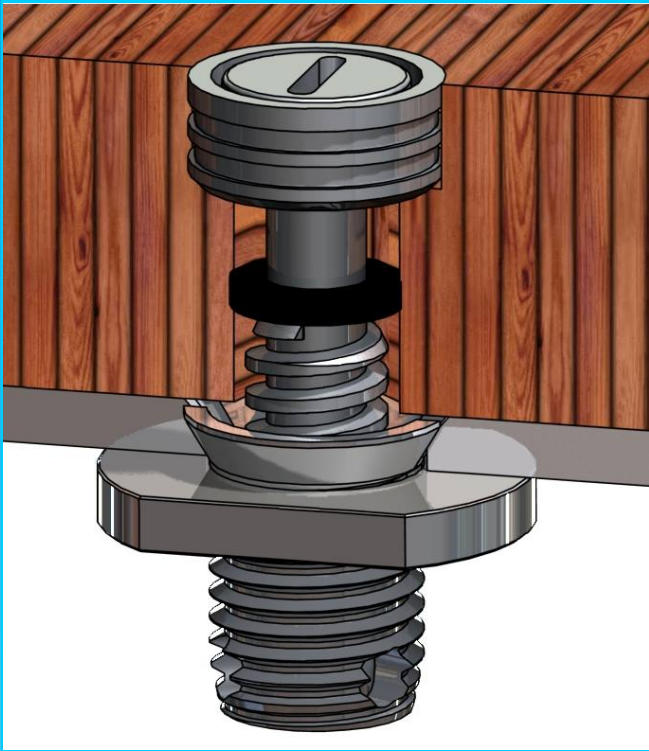

OEM Floor Anchors



OEM Floor Anchors

These Floor Anchors are designed to allow a .375 inch (9.525 mm) to .75 inch (19.505 mm) floor panel (C) to be attached and detached repeatedly.

The Floor Anchor system contains three main components, a Cupped Washer (A), a Panel Insert (G), and a Stringer Insert (H). A backing nut (F) is available when using a thin receptacle panel. All components are made from 304 stainless steel.

1. The Cupped Washer (A) works with the panel insert to help reduce the potential of gouging and strengthen the panel from pull through. There are small grooves on the outside to better hold epoxy.
2. The Panel Insert (G) holds the panel in place. Coarse threads match those inside of the stringer insert (H) for quick and effective removal and tightening. A flat rubber washer (B) between the cupped washer and head of the panel insert help to reduce potential water intrusion and keeps the panel fastener from backing out.
3. The Stringer Insert (H) screws into the stringer (E) with self tapping threads. The insert has a flared head for a flush finish and to help prevent it from penetrating too deep into the stringer. The backing nut (F) is available for the use of a thin receiving panel (image illustrates an installation using 1/8" angled steel).

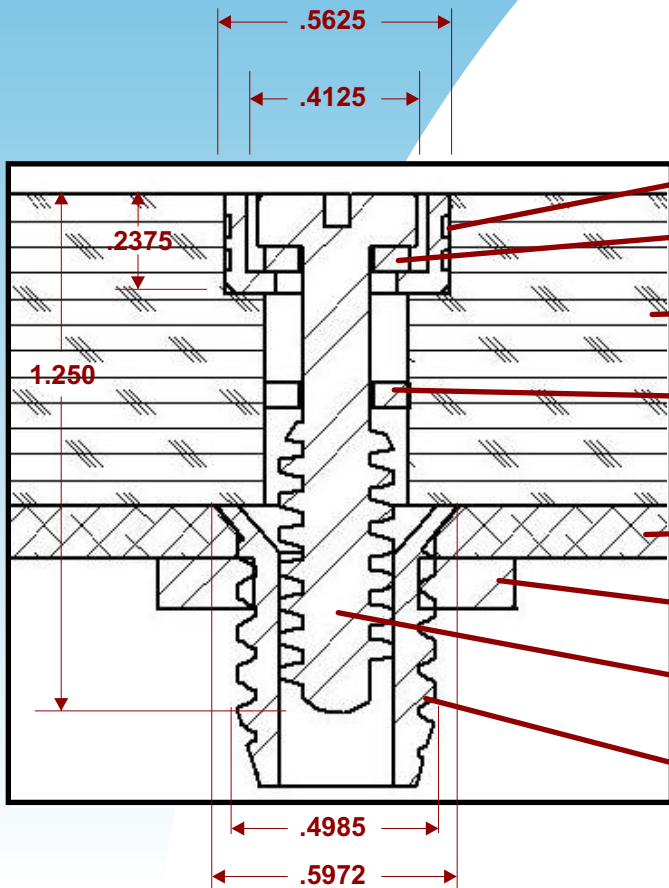

(A) Cupped Washer

(B) Flat Rubber Washer

(C) Floor Panel

**(D) Flat Rubber Washer
(acts as a retainer)**

(E) Stringer (1/8" angle)

**(F) Backing Nut
(for thin panels)**

(G) Panel Insert

**(H) Stringer Insert
(self tapping)**

